

Peter Kwasny GmbH, Heilbronner Str. 96
74831 Gundelsheim / Deutschland
Telefon: +496269 95-0, Fax: +496269 95-80
www.spraymax.com / www.kwasny.com / info@kwasny.de

SprayMax®
2K Fill In 400 ml for 2K HS solvent-based top coats
Series H
Art. Nr. 680088



Product

Description / Purpose

2-component spray can pre-filled with propellant, solvent and hardener for one filling of 2K solvent-based top coats using a suitable filling device.

Highly suitable for:

Lesonal CT Super Thane 2K S2000 Topcoat

Filling with a filling unit: Slightly twist and remove the spray head and fill the can with 100 ml of undiluted paint without hardener additives using the filling unit. We recommend sieving the paint before filling into the filling cap or funnel. Please observe the instructions provided by the equipment manufacturer. Replace the spray head by twisting slightly after filling. Then tune the can upside down and spray 1 - 2 times briefly. This cleans the valve and the riser and guarantees the function. Replace the cap and note the colour code and filling quantity on the can if necessary.

Filling quantity: 100 ml

733 g/l

VOC Value (EU)

Substrate

Primed, filled areas and well preserved factory or old paint (cleaned and sanded).

The damaged area must be dry and free of grease and dust and all rust needs to be removed.

Processing

Protection measures



Wear personal protection equipment.
(respiratory mask/gloves/goggles)
For more information, see safety data sheet.

Shake

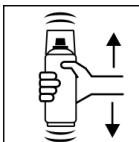

After filling with paint and before activating, shake can thoroughly for 2 minutes from when the mixing balls are heard.

Place red button

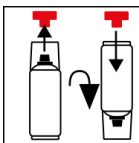

Remove the red button from the cap. Turn the can by 180° and fit the button onto the pin.

Press red button

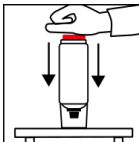

Turn the can upside down and place on a firm surface. Press the red button with the palm of your hand until it clicks into place.

Shake

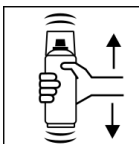

After activating, shake can again thoroughly for 2 minutes, again from when the mixing balls are heard.

Spray to test

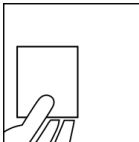

After shaking the can, test spray and check compatibility with the surface and the colour.

Spraying distance

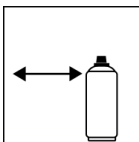

15 cm - 20 cm

Spray passes

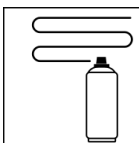

Dry film thickness 60 µm
(approx. 2 - 3 spray coats)

Flash-off time

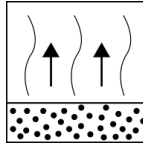

Flash time: approx. 5 min between spray coats

Processing conditions



Optimum application at 18° C - 25° C and a relative humidity from 40 - 60 %.

Drying

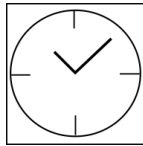

Please observe the information of the paint manufacturer.

Ready for polishing: 24 h

Continue

If necessary, polish with conventional polishes

Pot life

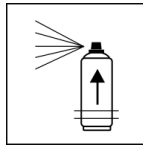

Approx. 24 h at 20° C room temperature and a relative humidity of approx. 40 - 50 %.

The processing time depends on the ambient temperature.

Higher temperatures reduce the pot life, lower temperatures will prolong it.

Finish

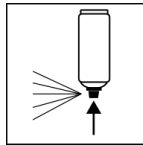

After painting, turn the can upside down and spray the valve until empty.

Additional Information

Important Information

The use of the can filled with paint depends heavily on the filled paint material. The information refers to processing 2K top coats and serves as general recommendations. Please observe the technical information of the paint manufacturer. Do not allow the spray can to stay for longer periods without the spray head as otherwise it may be difficult to attach the spray head. The respective FillClean cap set needs to be ordered separately for filling with the FillClean filling unit.

Shelf Life

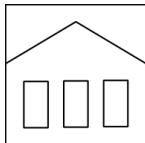

24 months (pre-gassed, not activated can that has not yet been filled with paint) The usage period refers to an unused can that is stored correctly at a temperature of 15 - 25° C and a relative humidity below 60%. The can must be stored and transported in an upright position in a dry place where it is protected against chemical and mechanical influences. The safety information on the can and all statutory provisions applicable for the storage site must be observed.

Disposal



The completely emptied spray cans must be disposed of in the recycling system. Cans with hardened material must be disposed of as special waste.

Note

For professional use only.

Identification, see safety data sheet.

The contents in this technical data sheet were created with great care and reflect our current state of knowledge. They provide the user with application-specific information and do not promise certain properties. The information is non-binding and we accept no liability for its integrity, accuracy and completeness. They do not relieve the user of their duty to check the suitability of our product for the intended purpose. The warnings printed on our labels must be respected. Our brands and patents are protected by copyright. All rights reserved We reserve the right to update, amend or supplement the content of the information without prior notice.